

roto slide seal R03-R

seal spec

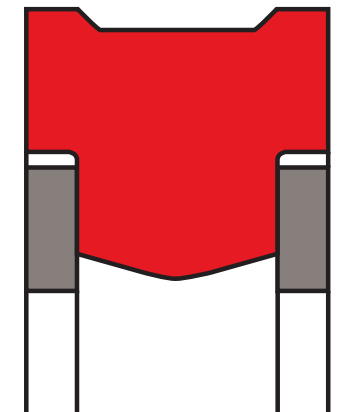

description

as profile R03-P but more adaptation possibilities for diverse temperatures and media by selection of suitable seal material.

application



not bolded symbols; please consult our technical for application limitations

category of profile

machined only.

double acting rotary shaft seal

operating parameters & material

diameter range: up to 600 mm

material		temperature	max. surface speed	max. pressure ¹
sealing element	back-up ring			
s-mart NBR	s-mart POM / s-mart PA ²	-30 °C ... +100 °C	0,2 m/s	250 bar (3600 psi)
s-mart HNBR	s-mart POM / s-mart PA ²	-25 °C ... +100 °C	0,2 m/s	250 bar (3600 psi)
s-mart FKM	s-mart PTFE virgin	-20 °C ... +200 °C	0,2 m/s	250 bar (3600 psi)
s-mart FKM	s-mart PTFE glass	-20 °C ... +200 °C	0,2 m/s	250 bar (3600 psi)
s-mart FKM	s-mart PTFE bronze	-20 °C ... +200 °C	0,2 m/s	250 bar (3600 psi)
s-mart FKM	s-mart PTFE carbon	-20 °C ... +200 °C	0,2 m/s	250 bar (3600 psi)

the stated operation conditions represent general indications. it is recommended not to use all maximum values simultaneously. surface speed limits apply only to the presence of adequate lubrication film.

¹ pressure ratings are dependent on the size of the extrusion gap.

² POM up to ø260 mm, PA above ø260 mm

surface quality

surface roughness	Rtmax (µm)	Ra (µm)
sliding surface	≤3	≤0,3
bottom of groove	≤10	≤1,8
groove face	≤16	≤3

tolerance recommendation

seal housing tolerances	
Ød	f7
ØD	H8



seal & housing recommendations

please note that we are able to produce those profiles to your specific need or any non standard housing. for detail measurements, please see seal-mart catalog...

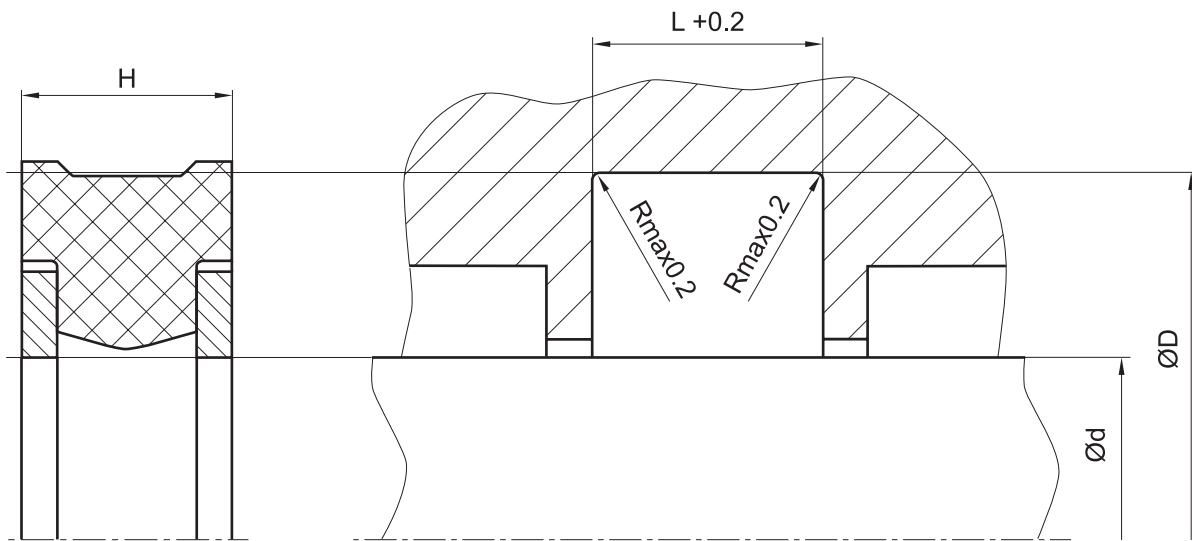

don't hesitate to contact our technical department for further information or for special requirements (temperature, speed etc.), so that suitable materials and/or designs can be recommended.